

EXTENSION OF USE (UK ONLY)

This extension of the authorized use provides for the uses of PRESTOP® in crops and situations other than those included in the product label above. No efficacy or phytotoxicity data have been assessed and, as such, the 'extension of use' is at all times the users' choice, being the commercial risk entirely theirs.

CONDITIONS OF USE

| Crops/situations | Application method | Maximum single dose | Maximum number of applications (per crop): | Latest time of application | Use specific restriction |
|---|--------------------|----------------------------------|--|--|---|
| Outdoor crops of almond, angelica, apple, apricot, asparagus, baby leaf crops, balm, basil, bay, beans without pods - fresh, bilberry, blackcurrant and redcurrant, blueberry, broad bean (fresh), broccoli / calabrese, Brussels sprout, bulb vegetables, cabbage, cane fruit, caraway leaves, cardoon, carrot, cauliflower, celeriac, celery, celery leaves, cherry chervil, chestnut, chicory root, chives, choi sum, collard, coriander leaves, cranberry, cress, dill leaves, dwarf french bean, edible flowers, edible podded pea, endive, fennel leaves, Florence fennel, fruiting vegetables, Globe artichoke, gooseberry, hazelnut herb - other, hops, horseradish, hyssop, Jerusalem artichoke, kale, kohlrabi, lamb's lettuce, land cress, leek, lentil (fresh), lettuce, lovage leaves, marjoram, medlar mint, oregano, oriental cabbage, ornamental plant production, parsley, parsley root, parsnip, peach and nectarine, pear, plum, quince, radish, red beet, rhubarb, rocket, rosemary, runner bean, sage, salad burnet, salsify, savory, seakale, soya bean (fresh), spinach, spinach beet, swede, sweet cicely, table grapes, tarragon, thyme, turnip, vining pea, walnut, wine grapes | Soil spray | 6 kg product / ha | 1 | Pre-crop emergence, pre-planting, sowing or drilling | - |
| | Soil drench | 500 g product / 100 litres water | 3 | - | When applied as a soil drench a maximum concentration of 500g product per 100 litres water must not be exceeded. |
| | Incorporation | 500 g product / m³ growth medium | 1 | Pre-planting, sowing or drilling | When applied as a growth media incorporation the maximum concentration must not exceed 500g product per cubic metre of growth media. |
| Outdoor crops of asparagus, cardoon, carrot, celeriac, celery, chicory root, Florence fennel, Globe artichoke, horseradish, Jerusalem artichoke, leek, parsley root, parsnip, radish, red beet, rhubarb, salsify, seakale, swede, turnip | Foliar spray | 6 kg product / ha | 3 | - | - |
| Outdoor angelica, outdoor baby leaf crops, outdoor balm, outdoor basil, outdoor bay, outdoor beans without pods - fresh, outdoor broad bean (fresh), outdoor broccoli / calabrese, outdoor Brussels sprout, outdoor cabbage, outdoor caraway leaves, outdoor cauliflower, celery leaves, chervil, outdoor chives, outdoor choi sum, outdoor collard, outdoor coriander leaves, outdoor cress, outdoor dill, outdoor dwarf french bean, outdoor edible flowers, edible podded pea, outdoor endive, fennel leaves, outdoor herb - other, outdoor hyssop, outdoor kale, outdoor kohlrabi, outdoor lamb's lettuce, outdoor land cress, outdoor lentil (fresh), outdoor lettuce, outdoor lovage leaves, outdoor marjoram, outdoor mint, outdoor oregano, outdoor oriental cabbage, outdoor parsley, outdoor rocket, outdoor rosemary, outdoor runner bean, outdoor sage, outdoor salad burnet, outdoor savory, outdoor soya bean, outdoor spinach, outdoor spinach beet, outdoor sweet cicely, outdoor tarragon, outdoor thyme, outdoor vining pea | Foliar spray | 6 kg product / ha | 3 | - | Applications to the crops which fall in to the Parent Groups of 'brassica vegetable', 'leaf vegetables' and 'fresh herbs' and legume vegetables (fresh) as described in the 'Crop Definition List' must not be made until the start of the inflorescence emergence stage (BBCH 50). |
| Outdoor bulb vegetables | Foliar spray | 6 kg product / ha | 3 | Before the development of harvestable vegetative plant parts stage (GS40). | Applications to bulb vegetables must not be made until after crop emergence (BBCH 9). |
| Outdoor fruiting vegetables | Foliar spray | 6 kg product / ha | 3 | Before first fruit on main stem has reached typical size and form (BBCH 71). | Applications to fruiting vegetables must not be made until after the start of inflorescence emergence stage (BBCH 50). |
| Outdoor hops | Foliar spray | 6 kg product / ha | 3 | Before the beginning of cone development: 10% of inflorescences are cones (BBCH 71). | - |
| Outdoor crops of table grapes, wine grapes | Foliar spray | 6 kg product / ha | Before the ripening of berries stage (GS80). | - | Applications to table and wine grapes must not be made until inflorescences are emerging (BBCH 50). |

To avoid risks to human health and the environment, comply with the instructions for use. The Control of Substances Hazardous to Health (COSHH) Regulations may apply to the use of this product at work.

SAFETY PRECAUTIONS

Operator protection

- Avoid breathing dust.
- Wear suitable protective clothing (coveralls), suitable protective gloves and respiratory protective equipment* when handling the concentrate or applying the product. *With disposable filtering facepiece respirator to at least EN 149 FFP2 or equivalent. However, engineering controls may replace personal protective equipment if a COSHH assessment (UK only) shows they provide an equal or higher standard of protection.
- If exposed or feeling unwell, call a poison center or a doctor/physician immediately.
- Do not eat, drink or smoke when using the product.
- If swallowed, seek medical advice immediately and show this container or label.
- Avoid contact with the eyes or the skin.
- In the event of contact with the eyes or the skin, rinse cautiously with water for several minutes.
- Wash hands and exposed skin thoroughly after handling.

Environmental protection

- Use appropriate containment to avoid environmental contamination.
 - Do not contaminate water with the product or its container (Do not clean application equipment near surface water/Avoid contamination via drains from farmyards and roads).
 - Since there is a risk to aquatic life from use, users not applying the statutory buffer zone must either themselves carry out (or ensure that someone else has carried out) a Local Environment Risk Assessment for Pesticides (LERAP) on their behalf before each spraying operation from a broadcast air-assisted sprayer. For broadcast air-assisted applications to wine grapes, table grapes and hops, users must not allow direct spray from such sprayers to fall within 10 m of the top of the bank of any static or flowing waterbody or within 5 m of a ditch which is dry at the time of application.
 - The LERAP indicates that a narrower buffer zone will be sufficient. Any measures indicated by the LERAP as justifying the narrower buffer zone are compiled with in full and in accordance with any conditions applicable to them.
 - Spray must be aimed away from water.
- Storage and disposal**
- Keep away from food, drink and animal feeding stuffs.
 - Keep out of reach of children.
 - Store in a closed container in a dry place.
 - Dispose of contents/container to a licensed hazardous waste disposal contractor or collection site except for clean empty containers which can be disposed of as non-hazardous waste.

IMPORTANT INFORMATION

FOR USE ONLY AS AN AGRICULTURAL/HORTICULTURAL FUNGICIDE
USER: Professional

| Crops/situations | Maximum single dose | Maximum total dose | Maximum number of applications | Latest time of application |
|--|---|--------------------|--|-----------------------------|
| Outdoor strawberry | 6 kg product/ha | 18 kg product/ha | 3 per crop (see Other Specific Restriction 1) | Before the end of flowering |
| All edible crops (protected), all non edible crops (protected) | 500 g product/m³ compost or soil (incorporated into growing medium) AND/OR See Other Specific Restriction 2 (applied as a spray/drench) | - | 1 per batch of growing medium See Other Specific Restriction 3 | - |

Other Specific Restrictions:

- A minimum interval of 1 week must be observed between applications.
- The maximum concentration must not exceed 500 g product per 100 litres water when applied as a spray or drench.
- A minimum interval of 3 weeks must be observed between applications on crops other than outdoor strawberry.

MIXING INSTRUCTIONS

Tank equipped with mechanic or hydraulic agitation system

- Start the agitation system and maintain this until and during the spraying operation. Fill half of the tank with clean water.
- Slowly pour the contents of the PRESTOP® bag(s) into the delivery system tank. Refer to the product label for the correct quantity required.
- Top up the delivery system tank with clean water.
- Keep mixing during application to maintain the product in suspension.

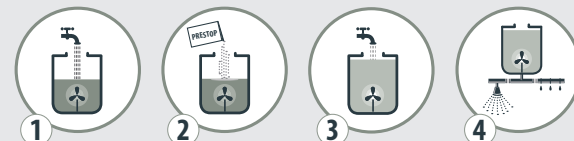

Tank with no agitation system: premixing preparation required

- Fill half of the premixing container (jug or bucket) with clean water.
- Slowly pour the contents of the PRESTOP® bag(s) into the premixing container. Refer to the product label for the correct quantity required.
- Mix the suspension very well for 5 minutes until a creamy suspension is achieved.
- Leave the mixture to stand for 20 minutes without mixing.
- Top up the premixing container with clean water. Mix the suspension very well for 5 minutes. The suspension is now ready to use.
- Fill the application/delivery system tank to the required volume. Apply the product mixture to crops as soon as possible. Do not leave mixed product standing in the delivery system tank.

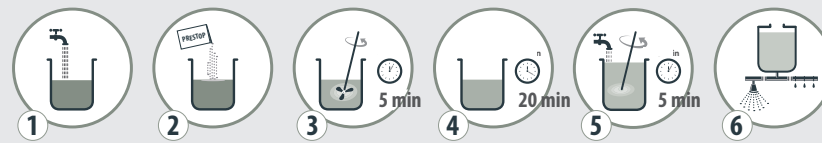

PRESTOP® is a registered trademark of Danstar Ferment AG, Switzerland. Batch number and production date printed/stamped on product package.



DANSTAR FERMENT A.G.
Poststrasse 30
6300 Zug
Switzerland
orders@lallemandplantcare.com

Approval holder:
DANSTAR FERMENT A.G.
Poststrasse 30
6300 Zug
Switzerland

DIRECTIONS FOR USE

IMPORTANT: This information is approved as part of the Product Label. All instructions within this section must be carefully read prior to using the product.

PRESTOP® is a biofungicide: a 32 % w/w wettable powder containing a nominal 2x10⁸ CFU/g product of the micro-organism *Glaciocladium catenulatum* strain J1446, a selected strain of a naturally occurring soil fungus. PRESTOP® is not genetically manipulated.

Crop recommendations

PRESTOP® is for use on all edible crops and all non-edible crops (protected) and outdoor strawberry.

Disease control

PRESTOP® provides moderate control of gummy stem blight (*Didymella* sp.), grey mould (*Botrytis* sp.), and damping-off and root diseases caused by *Pythium*, *Phytophthora*, *Rhizoctonia* and *Fusarium* spp. on all edible crops and all non-edible crops (protected) and outdoor strawberry.

- The *Glaciocladium* sp. fungus deprives plant pathogenic fungi of living space and nourishment by colonizing the plant roots or foliage before the pathogens.
- The *Glaciocladium* sp. fungus acts as a hyperparasite on harmful fungi by producing enzymes which break down the cell walls of the pathogenic fungi.

CROP SPECIFIC INFORMATION

FOLIAR APPLICATIONS

PRESTOP® gives moderate control of gummy stem blight (*Didymella* sp.) on cucumber, and grey mould (*Botrytis* sp.) on tomato, pepper, cucumber and strawberry, ornamentals and seedling production of all edible crops and all non-edible crops (protected) and outdoor strawberry.

Apply as a high volume foliar spray to ensure thorough coverage of the foliage, paying particular attention to stems when applying for *Didymella* sp. and wounds when applying for *Botrytis* sp.

Timing

- Tomato, pepper and cucumber: apply the first treatment soon after transplanting or at the latest immediately after de-leafing and reapply every 3-4 weeks.
- Ornamentals and seedling production of all edible crops and all non-edible crops (protected): treat cuttings at striking and seedlings at emergence, repeat at 3 to 4 week intervals.
- Strawberry: one to three applications as foliar spray at 0.5% or 0.6 g/m² (equivalent to 6.0 kg product/ha) with a seven day spray interval, at growth stages BBCH > 61 (at flowering).

Mixing and Spraying

PRESTOP® must always be used as an aqueous suspension. Follow the correct guidance instructions provided on this label. Apply at the rate of 500 g per 100 litres (0.5%). First, mix the PRESTOP® powder with a small amount of water (e.g. 1 litre). Then, agitate carefully until evenly mixed, after which dilute to the final concentration. Apply at high volume. As a guide for tomato, pepper and cucumber use 10 litres of PRESTOP® suspension per 500 plants, and for strawberries use 1,200 litres of the suspension per hectare at one application. Apply at high volume to just before run-off, ensuring thorough coverage of the crop.

Compatibility

PRESTOP® is a biological fungicide and may be affected by residues of or subsequent applications of other pesticide products. Consult the manufacturer or distributor regarding compatibility of other chemical or microbial products within a pest or disease control programme.

Do not tank-mix PRESTOP® with any chemical pesticides or concentrated fertilizer solutions.

PRESTOP® does not harm beneficial insects and can be used in integrated pest and disease control systems.

PRESTOP® has been used on a wide range of crops under a range of conditions and no phytotoxicity has been observed.

GROWING MEDIA APPLICATIONS

For the moderate control of damping-off and root diseases caused by *Pythium*, *Phytophthora*, *Rhizoctonia* and *Fusarium* spp. on all edible crops and all non-edible crops (protected) and outdoor strawberry. PRESTOP® may be applied by spraying or drenching, through drip irrigation or by mixing into the growing medium.

Timing

PRESTOP® should be used preventatively. Treat growing media at sowing, transplanting and/or planting stage. Repeat the treatment at the intervals of 4 to 6 weeks. Use the shorter interval under conditions of moderate to high disease pressure.

Mixing and Application

PRESTOP® must always be used as an aqueous suspension. Follow the correct guidance instructions provided on this label. Drench treatments may be applied via drip irrigation systems through a mixing tank or via a separate injection pump.

- Drench of cucumber, tomato, pepper, strawberry and ornamentals: apply 200 g to 250 g of PRESTOP® (0.5 %) per 1,000 plants.
- Drenching of small seedlings: use 5-10 g of PRESTOP®/m² in 1-2 litres of water/m² (0.5%).
- Drench of individual root balls and pot plants: apply 20 - 500 g of PRESTOP® (0.5%) per 1,000 plants, depending on the size (100 ml-1 l) of the root ball/pot.
- Growing media incorporation: when incorporating PRESTOP® into the growing medium use 200-500 g of PRESTOP® per 1,000 litres of the medium. Mix the powder first with water in order to ensure a uniform distribution of the product into the medium.

Always adjust the volume of water according to the moisture content of the growing media. Use the higher rate of PRESTOP® in the case of a risk for high disease pressure or big root volume. The lower rate is used when mild disease infection is expected, or for small root volume.

Resistance and storage

PRESTOP® has not been reported to have to cause any disease resistance. However, it is good practice to use such products as components of Integrated Pest Management (IPM) systems, alternating with other control measures. This is particularly important for sequential crops.

PRESTOP® is a biological preparation containing dried living fungal spores and Mycelium. PRESTOP® will keep unopened for one year if stored in cool, dry conditions below +4°C. Since PRESTOP® powder is hygroscopic, it is recommended to use the whole content of the package immediately once opened to prevent caking of the product. Alternatively, the opened package can be closed tightly and put in the freezer until the rest of the powder is used.

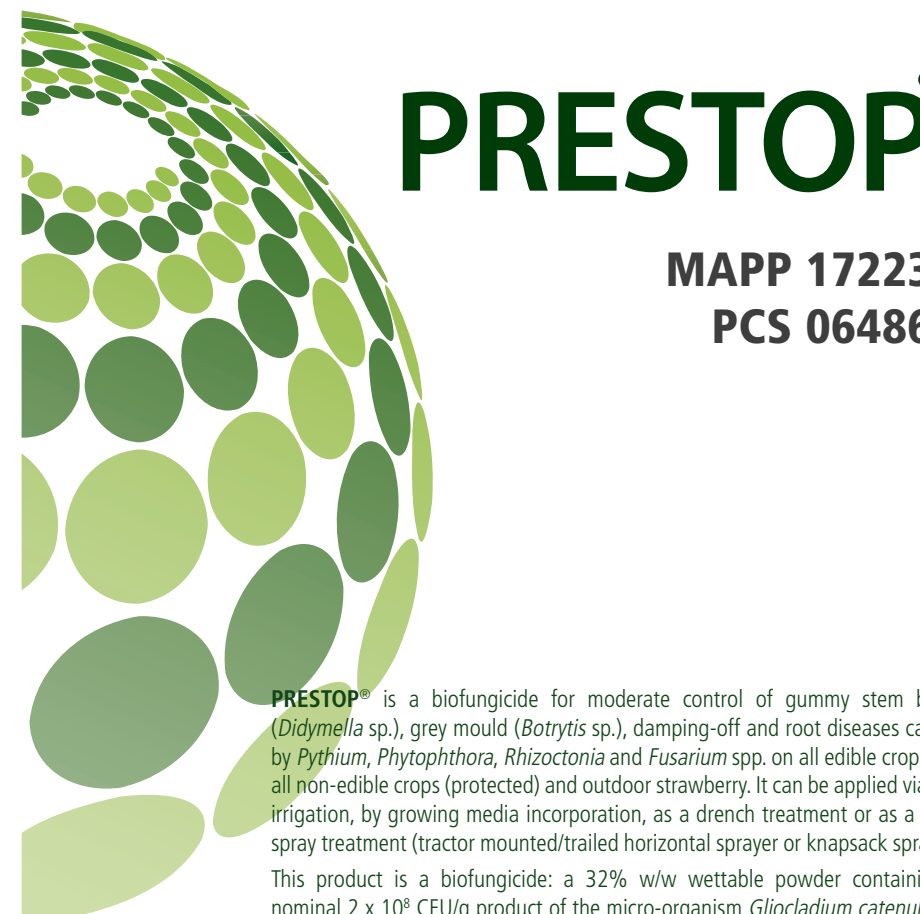

PRESTOP®

MAPP 17223 PCS 06486

PRESTOP® is a biofungicide for moderate control of gummy stem blight (*Didymella* sp.), grey mould (*Botrytis* sp.), damping-off and root diseases caused by *Pythium*, *Phytophthora*, *Rhizoctonia* and *Fusarium* spp. on all edible crops and all non-edible crops (protected) and outdoor strawberry. It can be applied via drip irrigation, by growing media incorporation, as a drench treatment or as a foliar spray treatment (tractor mounted/trailed horizontal sprayer or knapsack sprayer). This product is a biofungicide: a 32% w/w wettable powder containing a nominal 2 x 10⁸ CFU/g product of the micro-organism *Glaciocladium catenulatum* strain J1446.

NET WEIGHT

1 kg

READ THE LABEL BEFORE USE. USING THIS PRODUCT IN A MANNER THAT IS INCONSISTENT WITH THE LABEL MAY BE AN OFFENCE. FOLLOW THE CODE OF PRACTICE FOR USING PLANT PROTECTION PRODUCTS

Store below +4°C



LALLEMAND PLANT CARE

570722.08/20

OPEN HERE